



The Quad-Roof Kit MQA1601

⚠ WARNING: Read all assembly, field assembly and safety instructions associated with the MQP1600 The Quad prior to using this product. Always install this blind kit at ground level. Never attempt to install this product while quadpod is erect. Failure to follow these instructions may result in serious injury or death!

IMPORTANT NOTES:

These instructions assume you have fully assembled your existing **MQP1600 Quad** Quadpod. To ensure proper fit, finger tighten all nuts and bolts until instructed to fully tighten.

STEP 1. Insert the **roof supports** into the **welded sleeves** on the **rail supports** and secure using (4) 5/16" delta bolts from the inside. **NOTE:** The bends on the **roof supports** shall be to the top and pointing to the center of the **standing platform**.

STEP 2. Attach a **roof-side** to the inside of the two **roof supports** using (4) 1/4" x 1 3/4" hex bolts, (8) nylon washers and (4) 1/4" nylock nuts. Repeat for opposite side. Next, connect the **roof-sides** by attaching the **roof-tops** to the underside of the **roof-sides** and secure using (10) 1/4" x 1 3/4" hex bolts, (20) nylon washers and (10) 1/4" nylock nuts.

STEP 3. Carefully slide the **canopy** over the **roof assembly** (maintaining even pressure while pulling down the canopy over the edges and corners of the roof). Ensure the entry opening is on the same side as the front **standing platform** and secure by attaching bungee hooks to the underside of the **standing platform**.

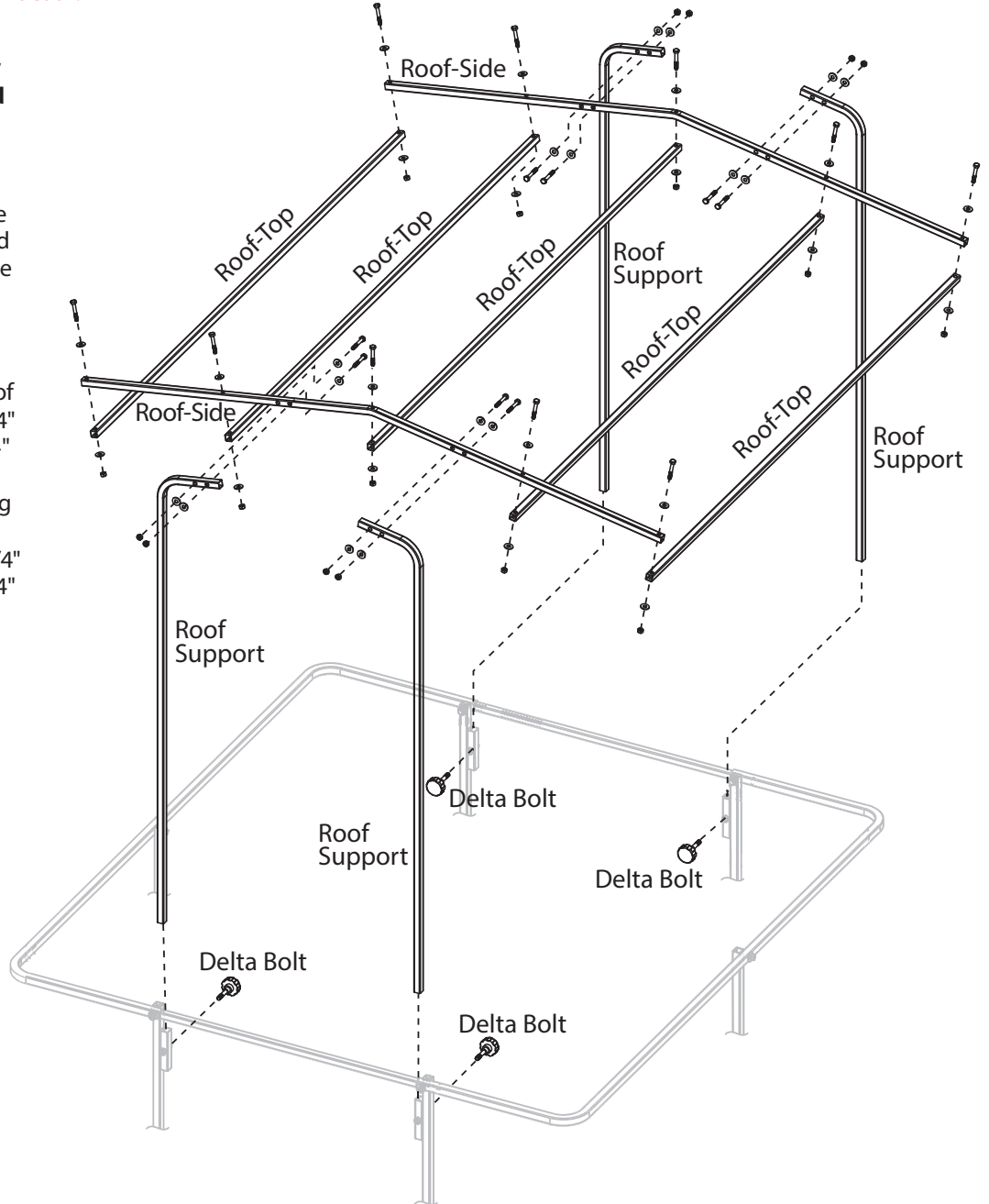

TOOLS Required for Assembly	
Adjustable Wrench	Qty 2

SPECIFICATIONS	
For use with MQP1600 Quad Quadpod	

Parts List		
Part #	Part Description	Qty
UP15-0130	Roof Support	4
UP15-0131	Roof-Side	2
UP15-0132	Roof-Top	5
UP15-0134	Canopy	1
UP17-0027	Instruction Manual	1
Hardware List		
UP77-0021	1/4" x 1 3/4" Hex Bolt	18
UP77-0033	5/16" x 1" Delta Bolt	4
UP77-0001	1/4" Nylock	18
UP77-0030	Nylon Washer	36

⚠ WARNING! DO NOT attempt to set-up this or any other Muddy® product(s) when thunderstorms are threatening and/or present within five (5) miles (8 km). Do not attempt to set-up this or any other Muddy® product(s) when any other adverse weather condition presents itself. These include weather conditions which have the potential for producing winds, lighting, rain, snow, sleet and/or any other atmospheric condition which may limit the user's ability to set-up this Muddy® product(s) in a safe manner as described in this Instruction Manual. Shall inclement weather conditions arise during your use of this Muddy® product(s), discontinue set-up of this Muddy® product(s) and immediately seek shelter. Failure to follow these instructions may result in serious injury or death!